

- Coach Areas
- Sleeper Bedrooms
- Food & Beverage**
- Toilets & Showers
- Common Use Areas

Amtrak® Long Distance Product Features

# Food & Beverage

- Coach Areas
- Sleeper Bedrooms
- Food & Beverage**
- Toilets & Showers
- Common Use Areas
- Crew Areas

Amtrak® Long Distance Product Features

# 08 | Cafe Counter

# Cafe Counter | Features

**Display Cabinets**  
Maximize available space for additional display items menus and Amtrak literature

**Digital Menus**  
Position at point of purchase

**Dry Display Area**  
Premium finishes

**Cold Display Fridges**

**Digital Menus**  
Aisle side and front side

**Branding Area**  
Area reserved for branding

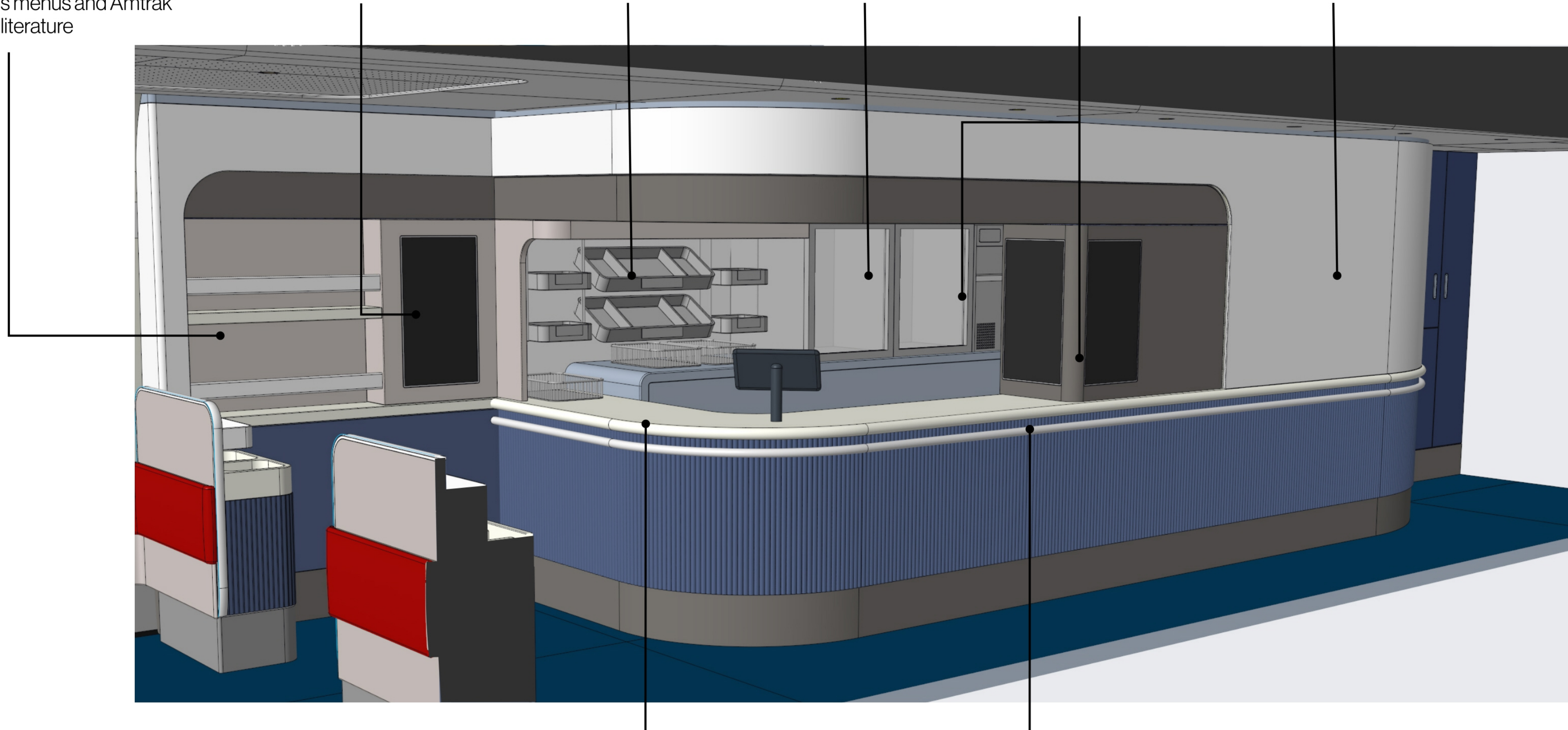

**Open Accessible Counter**  
Accessible counter height over entire length

**Handholds**  
Accessible handhold across entire length of Cafe wall

## Cafe Counter | Features

### Condiment Stations

Condiment stations to provide space for napkins, condiments and serving items, Shelf to rest a drink or snack. Trash bins maximized in lower area



# Cafe Counter | Lighting

**Ceiling Wash lights**  
Ceiling wash lights identical to with coach areas

**Display lighting**  
Lighting to highlight display items

**Counter spot lights**  
Down lights to illuminate counter and counter display

**Panel Spot Lights**  
Spot lights provide downlighting along aisle and at cafe counter

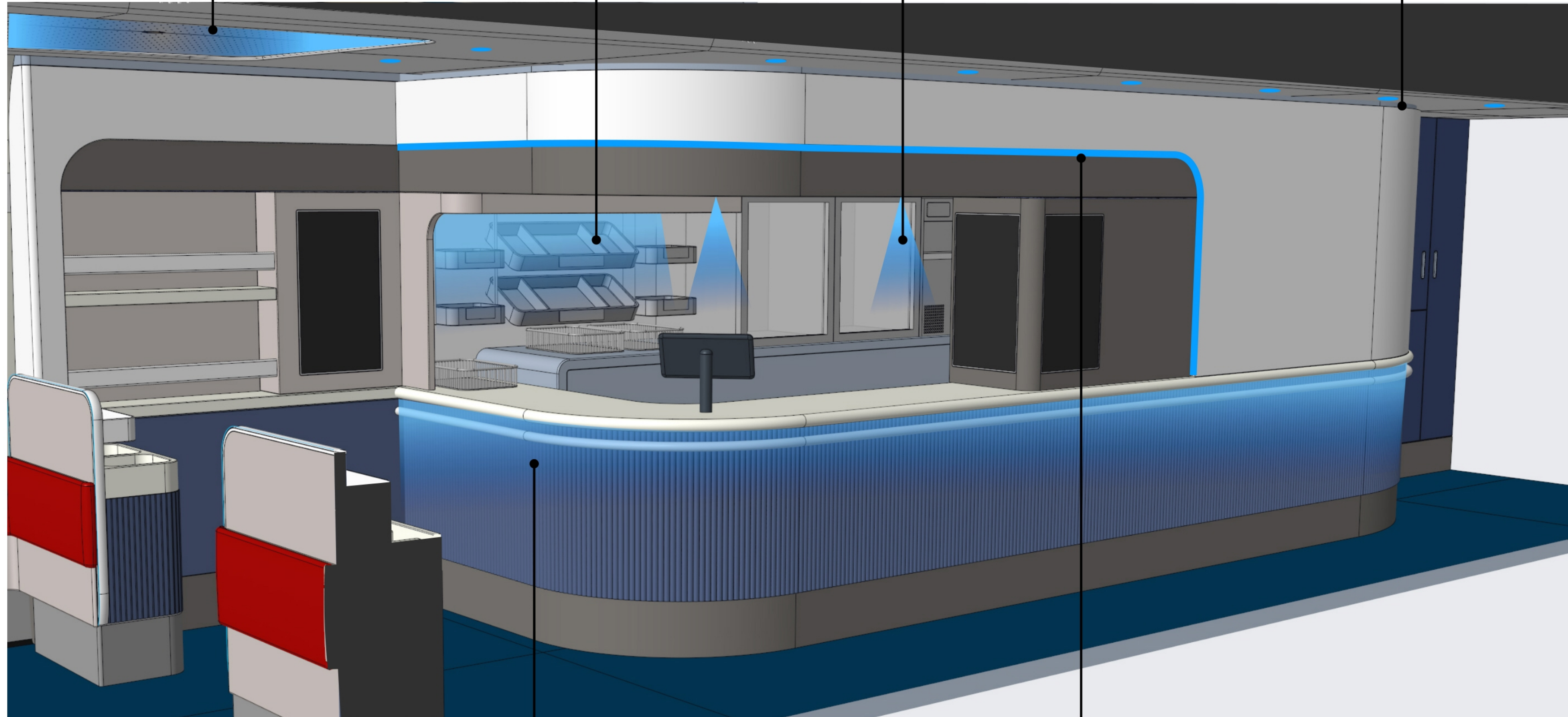

**Counter Wash Lights**  
Indirect light to wash down entire front edge of the Cafe counter

**Feature Light**  
Feature or pendant light

- Coach Areas
- Sleeper Bedrooms
- Food & Beverage**
- Toilets & Showers
- Common Use Areas

# 09 | Diner & Cafe Features

# Diner & Cafe | Seating Features

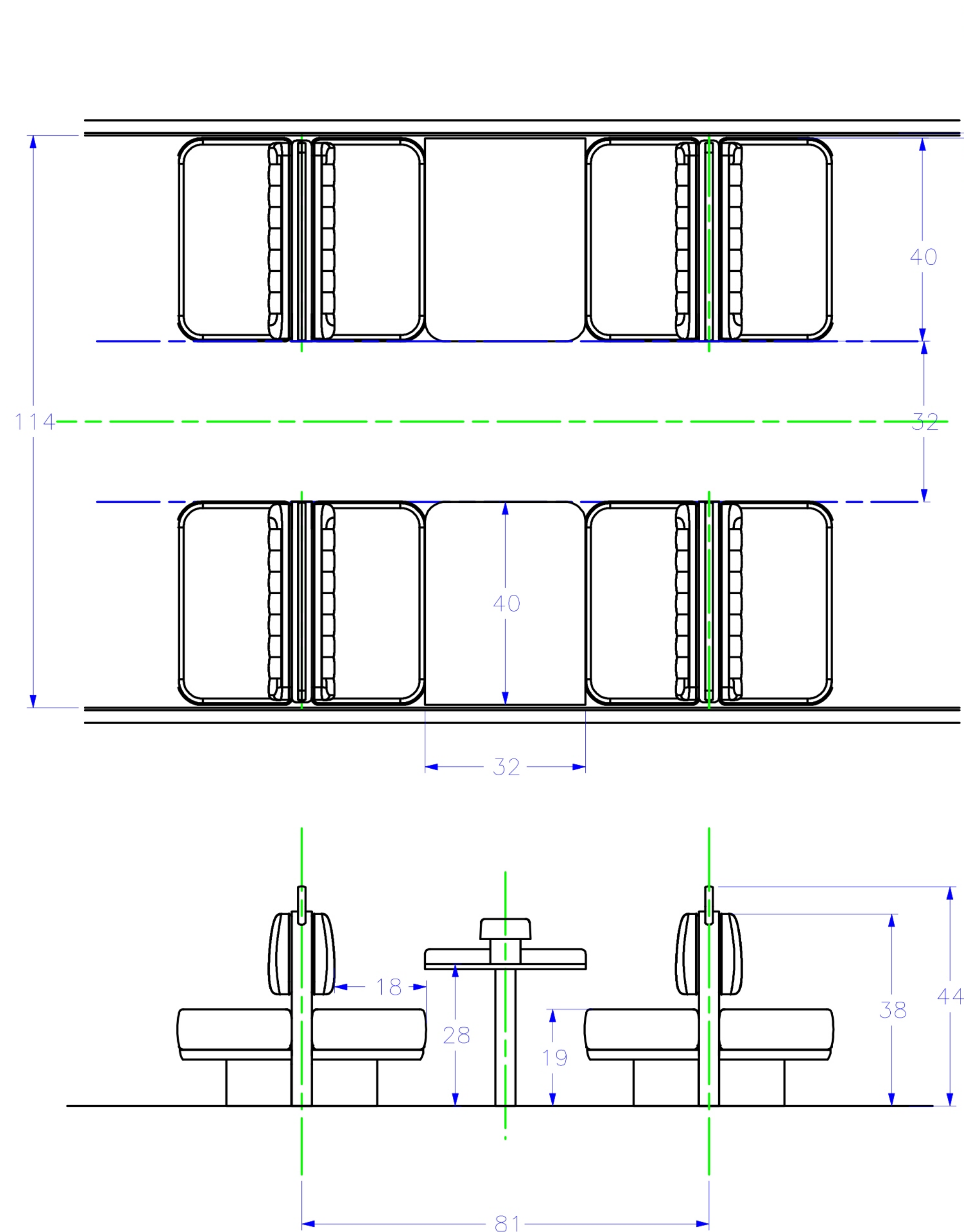

## Seat Dimensions

Seat width shall be maximized with a minimum acceptable dimension of 40" wide for a seat suitable for two passengers.

To achieve a 32" accessible path between diner seats, the side wall detail/clearance will need to be minimized and tolerances will need to be tightly controlled. Seat pan height shall be between 18" and 19" with a seat pan depth of no less than 18". Seat back height from finished floor should be a minimum of 38" with a higher divider no lower than 44".

All seat dimensions, cushion density/ shore hardness will be subject to mock-up review, testing and approval by Amtrak.

## Table Dimensions

A minimum usable table width of 32" shall be provided. Access in and out of the seat should be evaluated carefully. A tapered leading edge may be required to aid access to the seat. Top of table surface should be between 27" and 28" while also allowing 3" clearances in height for the legs of a 95 percentile male. Table leg location shall be positioned as to not provide a knee clash for passengers.

All table dimensions will be subject to mock-up review, testing and approval by Amtrak.

## Diner & Cafe | Seating Features

### Window Alignment

The center of the table should be central to the window with the center of the diner module in alignment with the window pillar repeating at an 81" pitch.

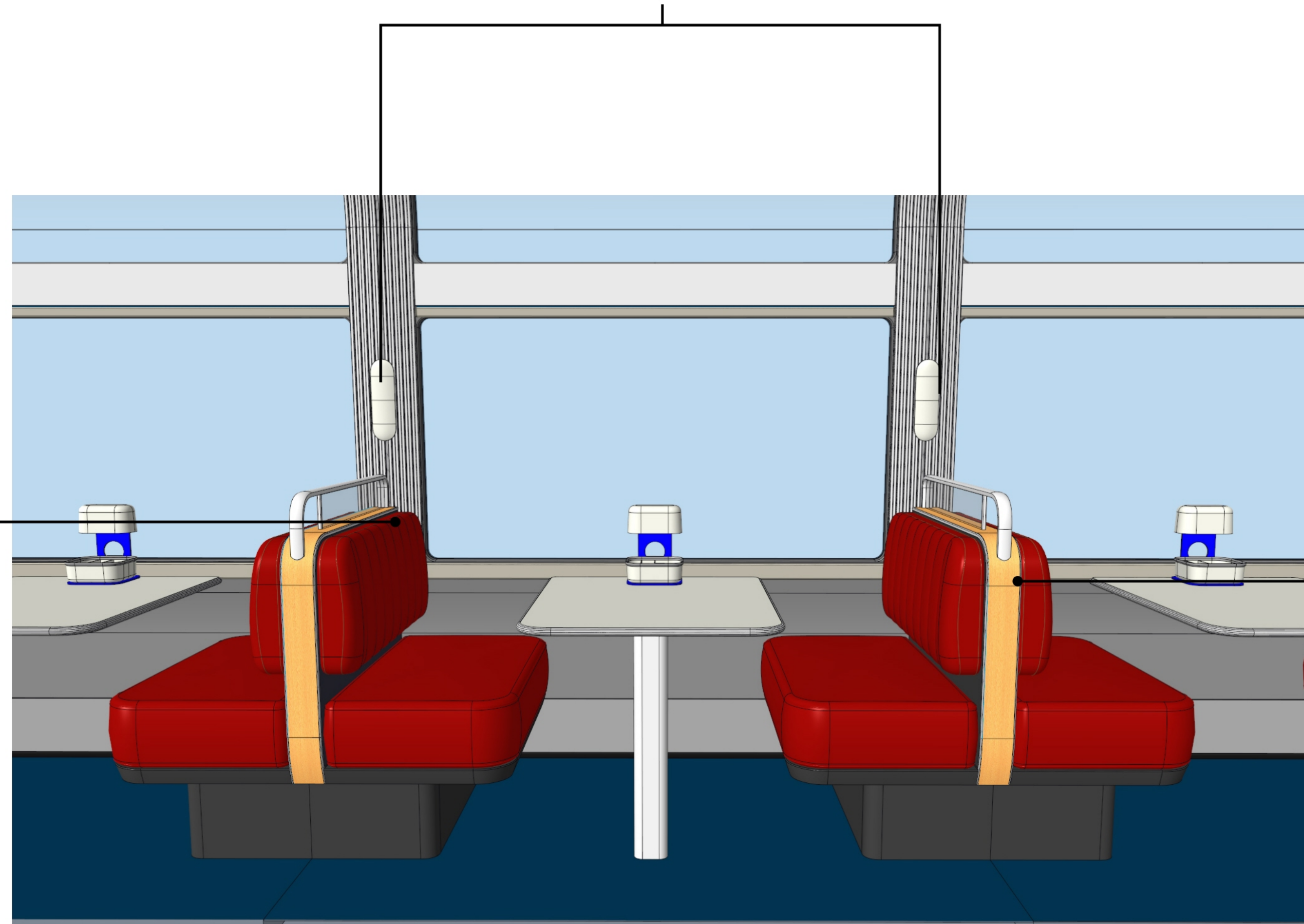

### Seat Comfort

Ergonomics, back support, seat back and seat pan pillowing, cushioning and seat trim and detailing will be evaluated and judged carefully during the design review process and will be subject to Amtrak approval.

### Seat Stowage

Booth seats should be designed with trunk type stowage in the base. The intention here is to provide extra stowage for crew only access to store emergency supplies. The access and design of the trunk stowage should not negatively impact the comfort or the aesthetic of the seat.

## Diner & Cafe | Seating Features



## Diner & Cafe | Lighting

### Table Booth Lamp

At each table position in the Diner a table lamp shall be provided. The lamp is intended to be a premium design feature that contributes to the overall lighting levels of the space.

### Wall Lamp

On each window pillar in Cafe, Diner and Lounge areas a wall lamp shall be provided that casts indirect light onto the pillar. The lamp is intended to be a premium design feature that contributes to the overall lighting levels of the space.

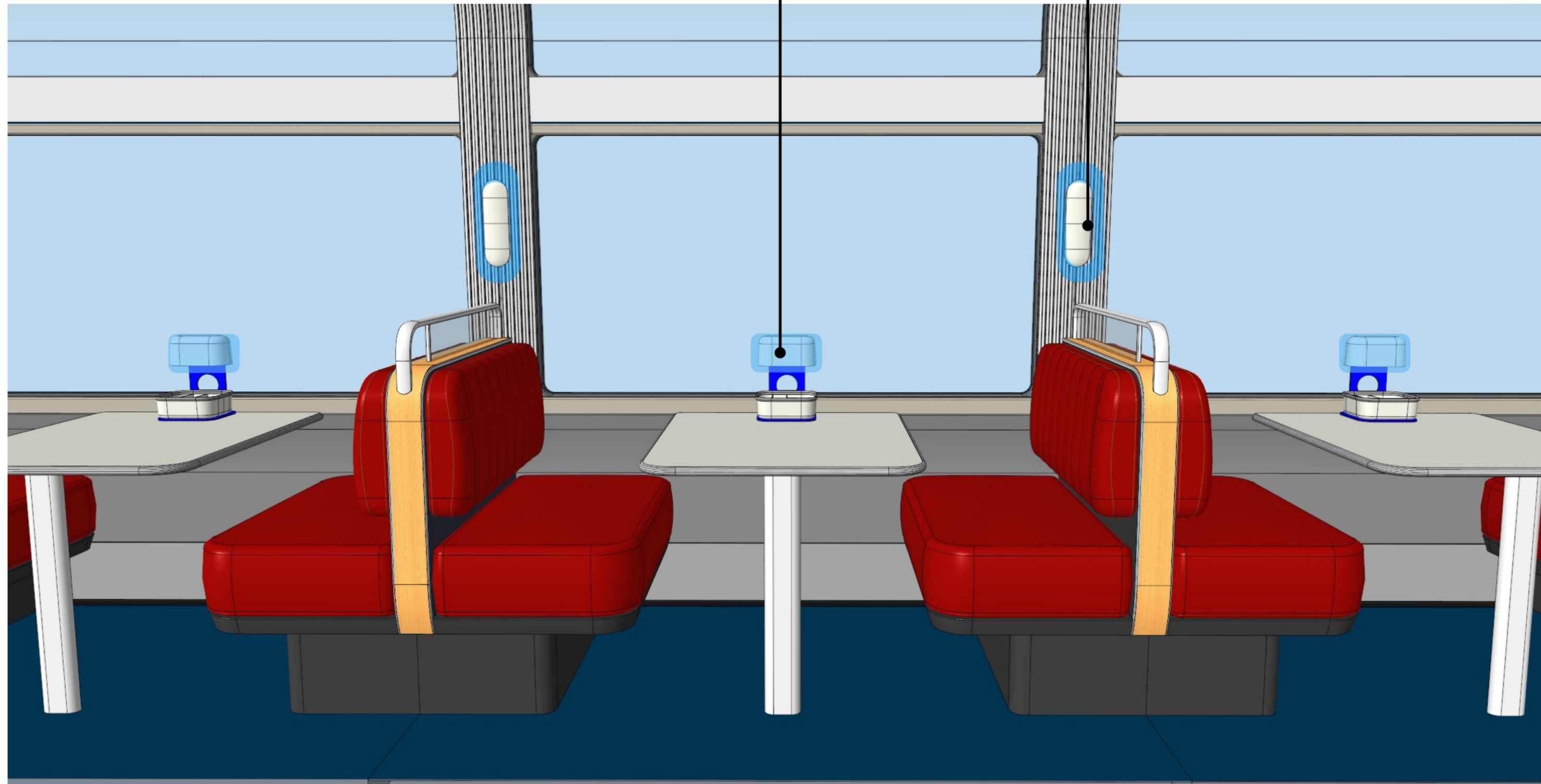

## Diner | Service Station

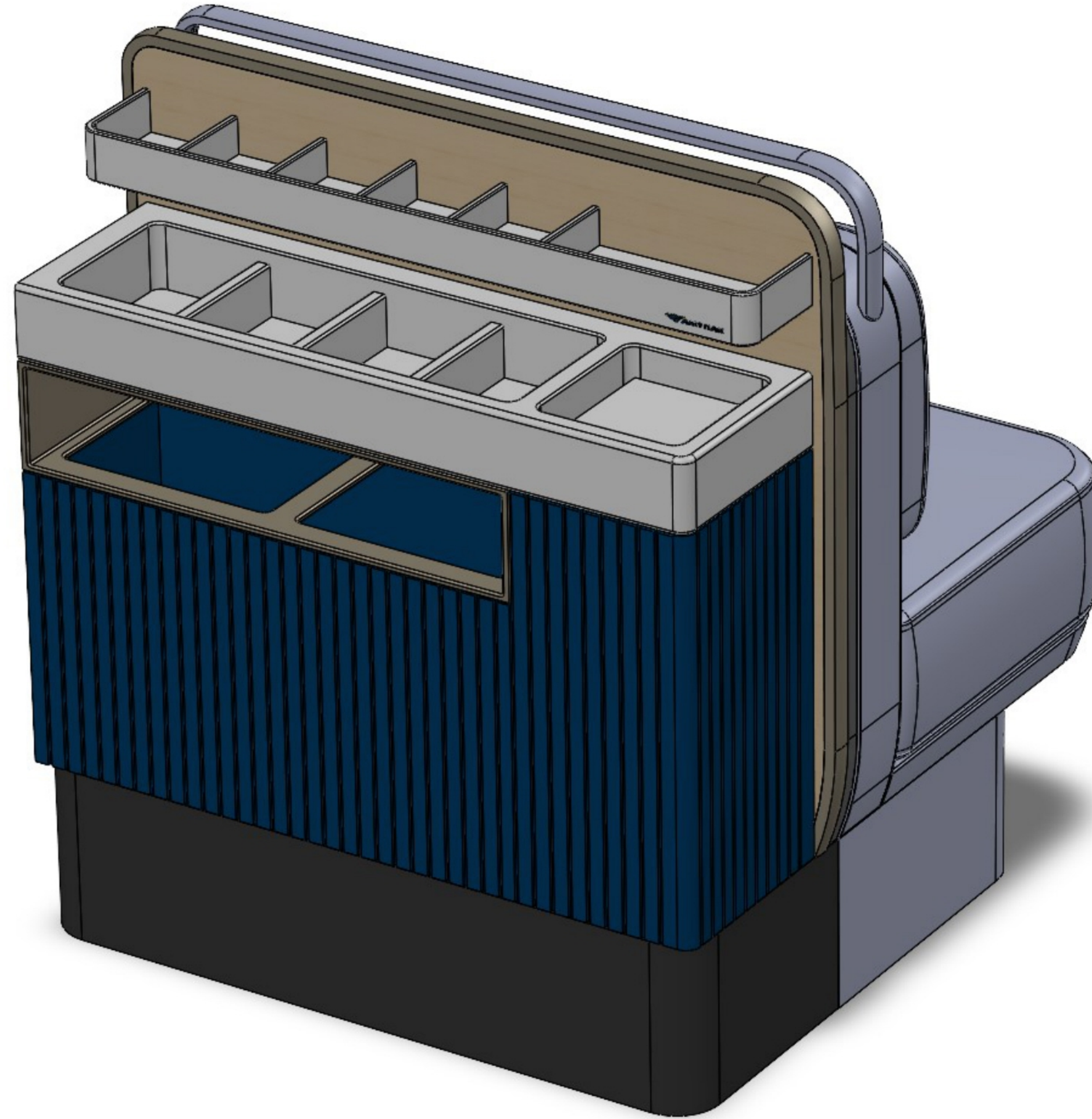

### **Service Station**

A service station should be provided within the Diner. The purpose of this station is to assist crew with performing an efficient food service. Crew will use the station to replenish the tables so should be designed to store provisions needed for table settings including cutlery, napkins (standard and small beverage) menus and items to support coffee service. It should have open storage and closed storage and may also require a trash bin.

- Coach Areas
- Sleeper Bedrooms
- Food & Beverage**
- Toilets & Showers
- Common Use Areas

Amtrak® Long Distance Product Features

# 10 | Lounge Features

# Lounge | Features

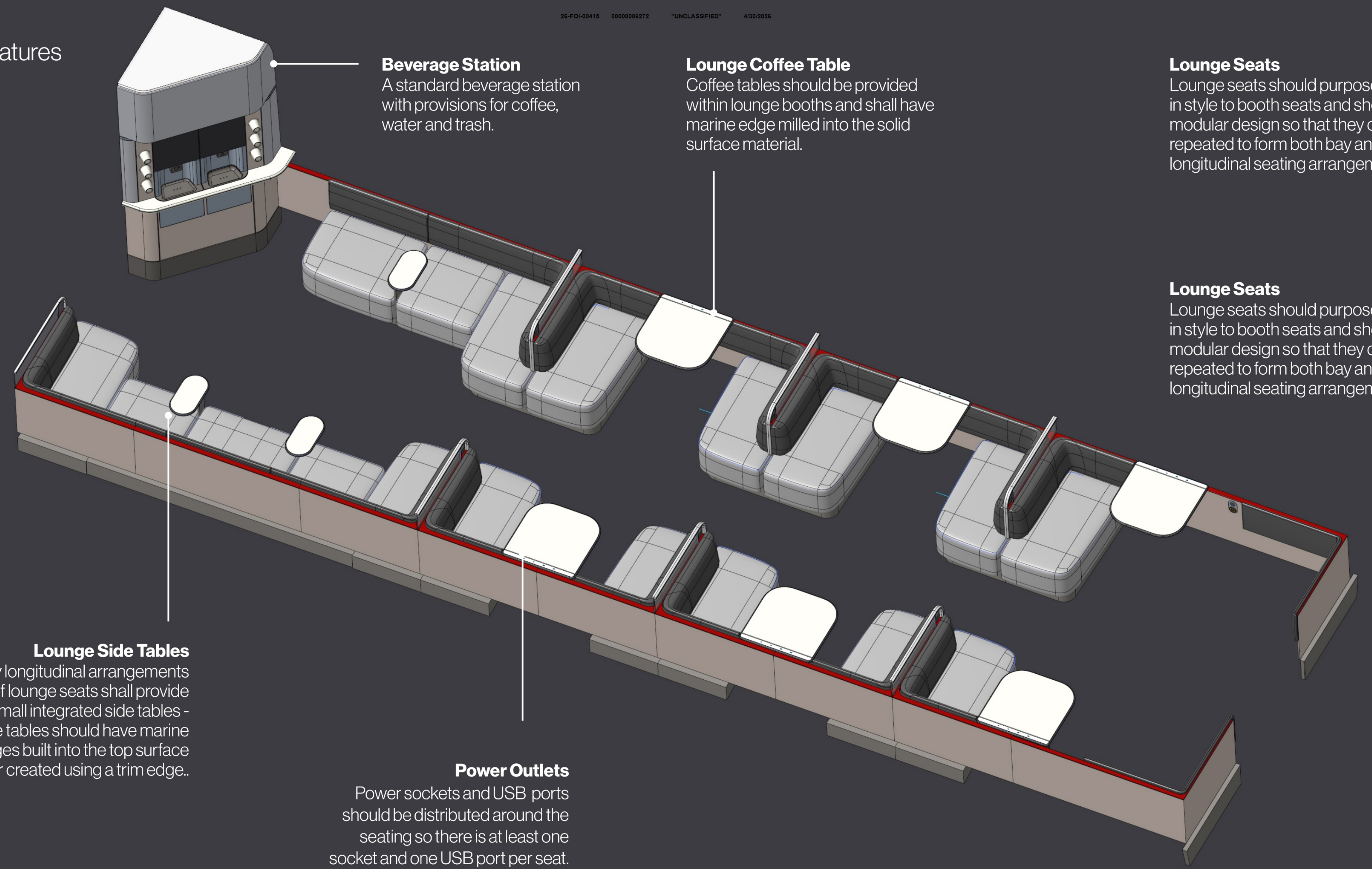

**Beverage Station**  
A standard beverage station with provisions for coffee, water and trash.

**Lounge Coffee Table**  
Coffee tables should be provided within lounge booths and shall have marine edge milled into the solid surface material.

**Lounge Seats**  
Lounge seats should purposefully differ in style to booth seats and should utilize modular design so that they can be repeated to form both bay and longitudinal seating arrangements.

**Lounge Seats**  
Lounge seats should purposefully differ in style to booth seats and should utilize modular design so that they can be repeated to form both bay and longitudinal seating arrangements.

**Lounge Side Tables**  
Any longitudinal arrangements of lounge seats shall provide small integrated side tables - side tables should have marine edges built into the top surface or created using a trim edge..

**Power Outlets**  
Power sockets and USB ports should be distributed around the seating so there is at least one socket and one USB port per seat.

## Lounge | Features

### Seating Dimensions

Lounge seats should have a minimum seat pan depth of 20" and a minimum seat width of 20". Seat pan height should be a minimum of 18".

### Seat Comfort

Ergonomics, back support, seat back and seat pan pillowing, cushioning and seat trim and detailing will be evaluated and judged carefully during the design review process and will be subject to Amtrak approval.

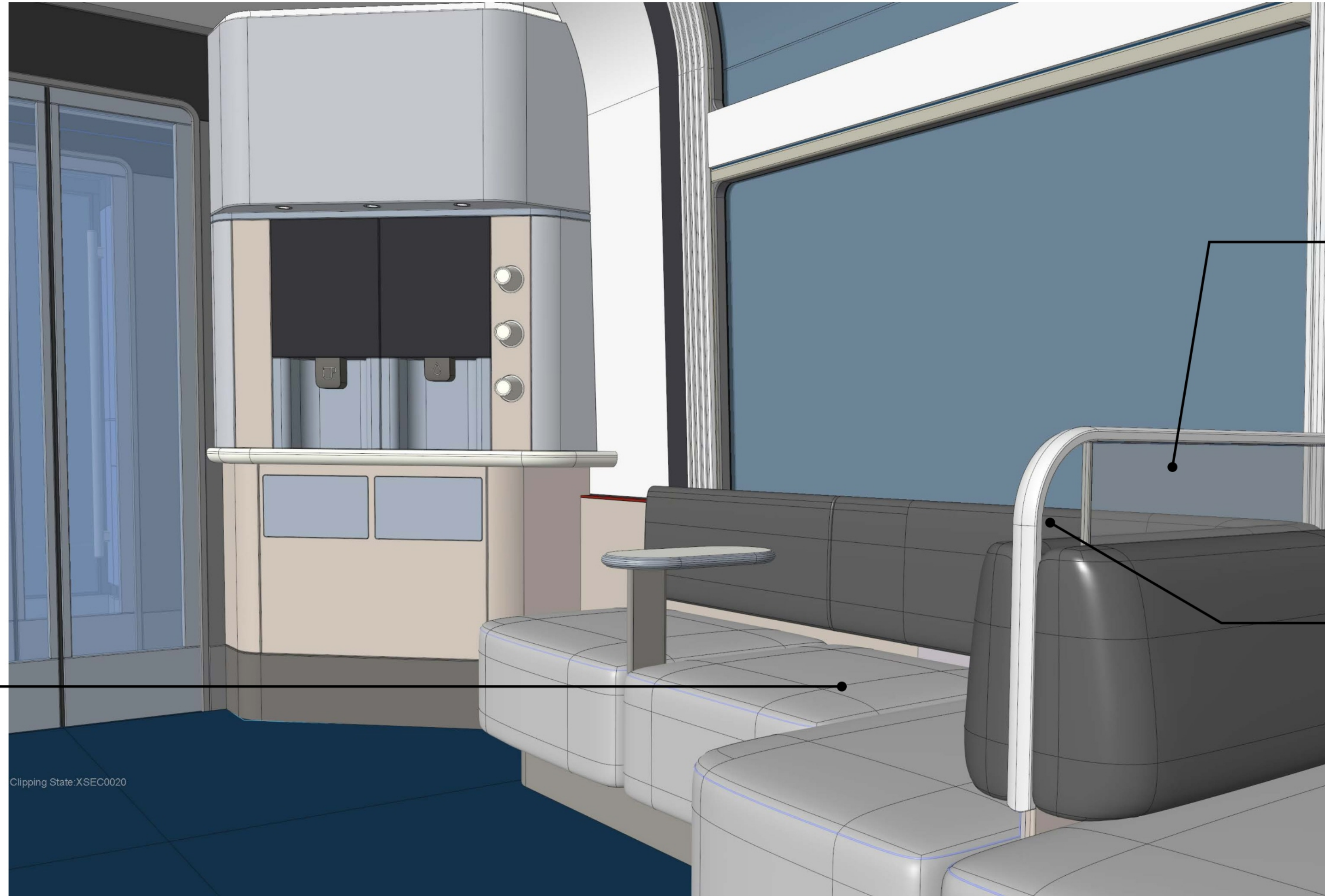

### Lounge Privacy Dividers

Privacy dividers should be included where seating is back-to-back. The height of the divider shall be low enough not to obstruct view out of the windows, yet high enough to provide some level of privacy for seated passengers.

### Grab Handles

Purposeful and compliant handholds integrated with the divider should be located on entry and exit points to lounge booths.